

COLLIDRILL PIPES SPECIFICATIONS

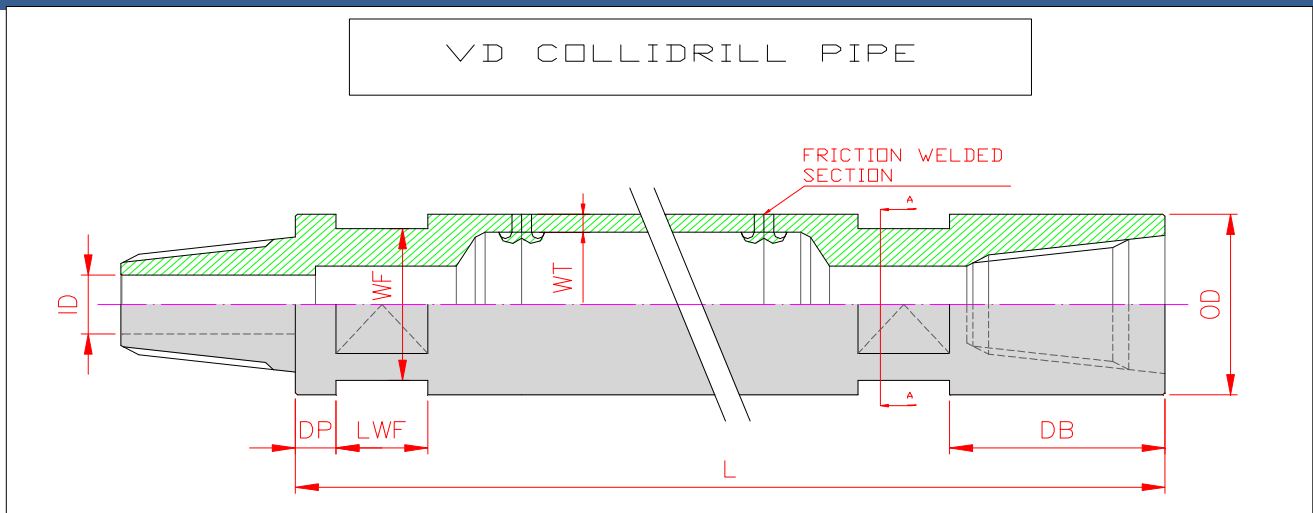

<b>DRILL PIPES</b>	OD		<b>76,10</b>	mm	<b>3,00</b>	inch
<b>2 3/8 AR</b>	WT		<b>6,30</b>	mm	<b>0,25</b>	inch

<b>max. COPPIA senza TIRO</b>				<b>max. TIRO senza COPPIA</b>		
<b>max. TORQUE without PULLBACK</b>				<b>max. PULLBACK without TORQUE</b>		
<b>Nm</b>	<b>ft-lbs</b>	CS-TQ	CS-PB	<b>KN</b>	<b>lbs</b>	<b>TON</b>
17150	12649	P	I	1381	310514	141
7795,45	5750	P	I	628	141143	64
<b>Nm</b>	<b>ft-lbs</b>	CS-TQ	CS-PB	<b>KN</b>	<b>lbs</b>	<b>TON</b>
11140	8216	P	I	898	201913	92
5063,64	3735	P	I	408	91779	42

<b>TIPO DI MATERIALE</b>						
<b>MATERIAL GRADE</b>						
<b>GRADO</b>	Rm MIN		Re min		COEF. SICUREZZA	
<b>GRADE</b>	Rm MIN		Re min		SAFETY FACTOR	
	<b>Mpa</b>	<b>psi</b>	<b>Mpa</b>	<b>psi</b>	<b>CONDITIONS</b>	
WITH S-135	1000	145000	931	135000	THEORETICAL	1
WITH S-135	1000	145000	931	135000	UNDER FATIGUE	2,2
	<b>Mpa</b>	<b>psi</b>	<b>Mpa</b>	<b>psi</b>	<b>CONDITIONS</b>	
WITH E355	650	94300	550	80000	THEORETICAL	1
WITH E355	650	94300	550	80000	UNDER FATIGUE	2,2

<b>PESO</b>		<b>LUNGHEZZA</b>		<b>PIANI CHIAVE</b>			<b>LARGHEZZA E POSIZIONAMENTO PIANI CHIAVE</b>						<b>DIAM. INTERNO</b>		<b>CODICE PRODOTTO</b>
<b>WEIGHT</b>		<b>LENGTH</b>		<b>BRANCH FLATS - WF</b>			<b>WF LENGTH - LWF</b>		<b>DP</b>		<b>DB</b>		<b>INTERNAL DIAM.</b>		<b>PRODUCT CODE</b>
Kg	lbs	mm	ft	n°	mm	inch	mm	inch	mm	inch	mm	inch	mm	inch	
14	30,9	1000	3,28	4	65	2,56	40	1,57	15,3	0,60	91,5	3,60	29	1,14	
20	44,1	1500	4,92	4	65	2,56	40	1,57	15,3	0,60	91,5	3,60	29	1,14	
25	55,1	2000	6,56	4	65	2,56	40	1,57	15,3	0,60	91,5	3,60	29	1,14	
36	79,4	3000	9,84	4	65	2,56	40	1,57	15,3	0,60	91,5	3,60	29	1,14	
53	116,9	4500	14,76	4	65	2,56	40	1,57	15,3	0,60	91,5	3,60	29	1,14	
70	154,4	6000	19,69	4	65	2,56	40	1,57	15,3	0,60	91,5	3,60	29	1,14	

<b>DRILL PIPES</b>	OD		<b>76,10</b>	mm	<b>3,00</b>	inch
<b>2 3/8 AR</b>	WT		<b>4,00</b>	mm	<b>0,16</b>	inch

<b>max. COPPIA senza TIRO</b>				<b>max. TIRO senza COPPIA</b>		
<b>max. TORQUE without PULLBACK</b>				<b>max. PULLBACK without TORQUE</b>		
<b>Nm</b>	<b>ft-lbs</b>	CS-TQ	CS-PB	<b>KN</b>	<b>lbs</b>	<b>TON</b>
17150	12649	P	I	906	203712	92
7795,45	5750	P	I	412	92596	42
<b>Nm</b>	<b>ft-lbs</b>	CS-TQ	CS-PB	<b>KN</b>	<b>lbs</b>	<b>TON</b>
11140	8216	P	I	589	132435	60
5063,64	3735	P	I	268	60198	27

<b>TIPO DI MATERIALE</b>						
<b>MATERIAL GRADE</b>						
<b>GRADO</b>	Rm MIN		Re min		COEF. SICUREZZA	
<b>GRADE</b>	Rm MIN		Re min		SAFETY FACTOR	
	<b>Mpa</b>	<b>psi</b>	<b>Mpa</b>	<b>psi</b>	<b>CONDITIONS</b>	
WITH S-135	1000	145000	931	135000	THEORETICAL	1
WITH S-135	1000	145000	931	135000	UNDER FATIGUE	2,2
	<b>Mpa</b>	<b>psi</b>	<b>Mpa</b>	<b>psi</b>	<b>CONDITIONS</b>	
WITH E355	650	94300	550	80000	THEORETICAL	1
WITH E355	650	94300	550	80000	UNDER FATIGUE	2,2

<b>PESO</b>		<b>LUNGHEZZA</b>		<b>PIANI CHIAVE</b>			<b>LARGHEZZA E POSIZIONAMENTO PIANI CHIAVE</b>						<b>DIAM. INTERNO</b>		<b>CODICE PRODOTTO</b>
<b>WEIGHT</b>		<b>LENGTH</b>		<b>BRANCH FLATS - WF</b>			<b>WF LENGTH - LWF</b>		<b>DP</b>		<b>DB</b>		<b>INTERNAL DIAM.</b>		<b>PRODUCT CODE</b>
Kg	lbs	mm	ft	n°	mm	inch	mm	inch	mm	inch	mm	inch	mm	inch	
11	24,3	1000	3,28	4	65	2,56	40	1,57	15,3	0,60	91,5	3,60	29	1,14	
14,5	32,0	1500	4,92	4	65	2,56	40	1,57	15,3	0,60	91,5	3,60	29	1,14	
18	39,7	2000	6,56	4	65	2,56	40	1,57	15,3	0,60	91,5	3,60	29	1,14	
25,5	56,2	3000	9,84	4	65	2,56	40	1,57	15,3	0,60	91,5	3,60	29	1,14	
36,5	80,5	4500	14,76	4	65	2,56	40	1,57	15,3	0,60	91,5	3,60	29	1,14	
47,5	104,7	6000	19,69	4	65	2,56	40	1,57	15,3	0,60	91,5	3,60	29	1,14	

COLLIDRILL PIPES SPECIFICATIONS

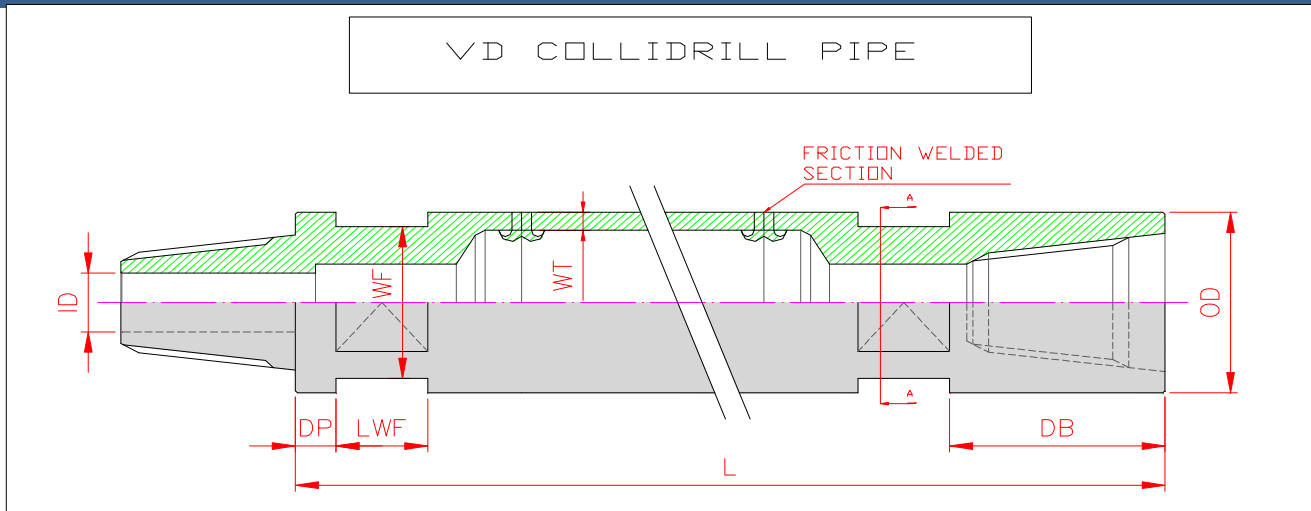

<b>DRILL PIPES</b>	OD		<b>88,90</b>	mm	<b>3,50</b>	inch
<b>2 3/8 AR</b>	WT		<b>6,30</b>	mm	<b>0,25</b>	inch

<b>max. COPPIA senza TIRO</b>				<b>max. TIRO senza COPPIA</b>		
<b>max. TORQUE without PULLBACK</b>				<b>max. PULLBACK without TORQUE</b>		
<b>Nm</b>	<b>ft-lbs</b>	CS-TQ	CS-PB	<b>KN</b>	<b>lbs</b>	<b>TON</b>
17150	12649	P	I	1635	367626	167
7795,45	5750	P	I	743	167103	76
<b>Nm</b>	<b>ft-lbs</b>	CS-TQ	CS-PB	<b>KN</b>	<b>lbs</b>	<b>TON</b>
11140	8216	P	I	1063	239013	108
5063,64	3735	P	I	483	108642	49

<b>TIPO DI MATERIALE</b>						
<b>MATERIAL GRADE</b>						
<b>GRADO</b>	<b>Rm MIN</b>		<b>Re min</b>		<b>COEF. SICUREZZA</b>	
<b>GRADE</b>	<b>Rm MIN</b>		<b>Re min</b>		<b>SAFETY FACTOR</b>	
	<b>Mpa</b>	<b>psi</b>	<b>Mpa</b>	<b>psi</b>	<b>CONDITIONS</b>	
WITH S-135	1000	145000	931	135000	THEORETICAL	1
WITH S-135	1000	145000	931	135000	UNDER FATIGUE	2,2
	<b>Mpa</b>	<b>psi</b>	<b>Mpa</b>	<b>psi</b>	<b>CONDITIONS</b>	
WITH E355	650	94300	550	80000	THEORETICAL	1
WITH E355	650	94300	550	80000	UNDER FATIGUE	2,2

PESO		LUNGHEZZA		PIANI CHIAVE			LARGHEZZA E POSIZIONAMENTO PIANI CHIAVE						DIAM. INTERNO		CODICE PRODOTTO
WEIGHT		LENGTH		WRANCH FLATS - WF			WF LENGTH - LWF		DP		DB		INTERNAL DIAM.		PRODUCT CODE
Kg	lbs	mm	ft	n°	mm	inch	mm	inch	mm	inch	mm	inch	mm	inch	
19	41,9	1000	3,28	4	75	2,95	40	1,57	17,8	0,70	94	3,70	29	1,14	
24,5	54,0	1500	4,92	4	75	2,95	40	1,57	17,8	0,70	94	3,70	29	1,14	
31	68,4	2000	6,56	4	75	2,95	40	1,57	17,8	0,70	94	3,70	29	1,14	
44	97,0	3000	9,84	4	75	2,95	40	1,57	17,8	0,70	94	3,70	29	1,14	
64	141,1	4500	14,76	4	75	2,95	40	1,57	17,8	0,70	94	3,70	29	1,14	
84	185,2	6000	19,69	4	75	2,95	40	1,57	17,8	0,70	94	3,70	29	1,14	

<b>DRILL PIPES</b>	OD		<b>88,90</b>	mm	<b>3,50</b>	inch
<b>2 3/8 AR</b>	WT		<b>4,00</b>	mm	<b>0,16</b>	inch

<b>max. COPPIA senza TIRO</b>				<b>max. TIRO senza COPPIA</b>		
<b>max. TORQUE without PULLBACK</b>				<b>max. PULLBACK without TORQUE</b>		
<b>Nm</b>	<b>ft-lbs</b>	CS-TQ	CS-PB	<b>KN</b>	<b>lbs</b>	<b>TON</b>
17150	12649	P	I	1067	239912	109
7795,45	5750	P	I	485	109051	49
<b>Nm</b>	<b>ft-lbs</b>	CS-TQ	CS-PB	<b>KN</b>	<b>lbs</b>	<b>TON</b>
11140	8216	P	I	693	155819	71
5063,64	3735	P	I	315	70827	32

<b>TIPO DI MATERIALE</b>						
<b>MATERIAL GRADE</b>						
<b>GRADO</b>	<b>Rm MIN</b>		<b>Re min</b>		<b>COEF. SICUREZZA</b>	
<b>GRADE</b>	<b>Rm MIN</b>		<b>Re min</b>		<b>SAFETY FACTOR</b>	
	<b>Mpa</b>	<b>psi</b>	<b>Mpa</b>	<b>psi</b>	<b>CONDITIONS</b>	
WITH S-135	1000	145000	931	135000	THEORETICAL	1
WITH S-135	1000	145000	931	135000	UNDER FATIGUE	2,2
	<b>Mpa</b>	<b>psi</b>	<b>Mpa</b>	<b>psi</b>	<b>CONDITIONS</b>	
WITH E355	650	94300	550	80000	THEORETICAL	1
WITH E355	650	94300	550	80000	UNDER FATIGUE	2,2

PESO		LUNGHEZZA		PIANI CHIAVE			LARGHEZZA E POSIZIONAMENTO PIANI CHIAVE						DIAM. INTERNO		CODICE PRODOTTO
WEIGHT		LENGTH		WRANCH FLATS - WF			WF LENGTH - LWF		DP		DB		INTERNAL DIAM.		PRODUCT CODE
Kg	lbs	mm	ft	n°	mm	inch	mm	inch	mm	inch	mm	inch	mm	inch	
14,5	32,0	1000	3,28	4	75	2,95	40	1,57	17,8	0,70	94	3,70	29	1,14	
19	41,9	1500	4,92	4	75	2,95	40	1,57	17,8	0,70	94	3,70	29	1,14	
23	50,7	2000	6,56	4	75	2,95	40	1,57	17,8	0,70	94	3,70	29	1,14	
32	70,6	3000	9,84	4	75	2,95	40	1,57	17,8	0,70	94	3,70	29	1,14	
44,5	98,1	4500	14,76	4	75	2,95	40	1,57	17,8	0,70	94	3,70	29	1,14	
57,5	126,8	6000	19,69	4	75	2,95	40	1,57	17,8	0,70	94	3,70	29	1,14	

COLLIDRILL PIPES SPECIFICATIONS

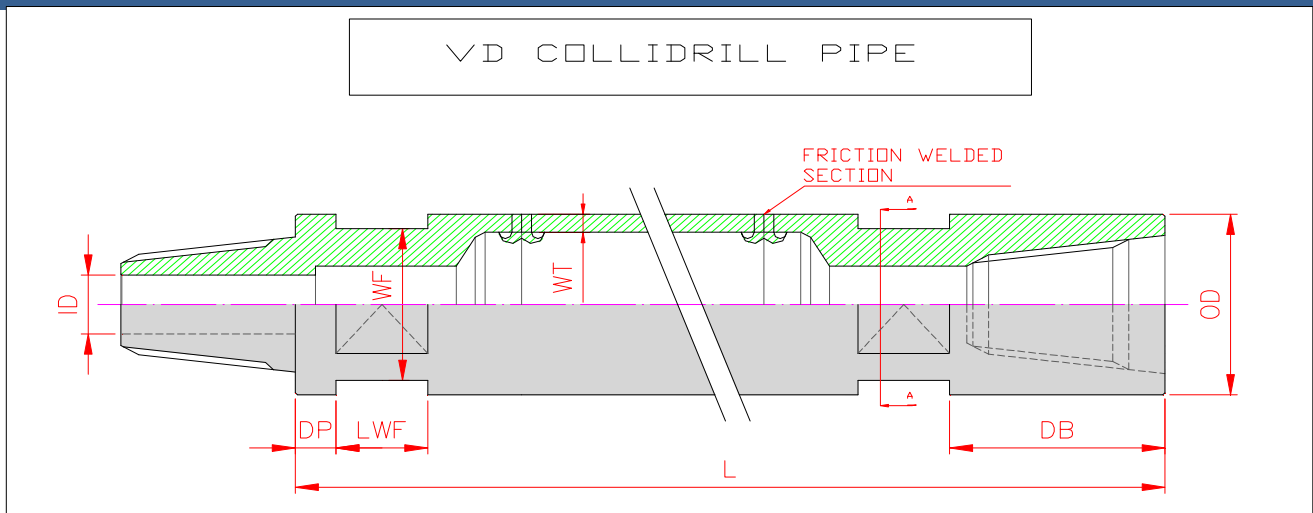

<b>DRILL PIPES</b>	OD		<b>88,90</b>	mm	<b>3,50</b>	inch
<b>2 3/8 IF (NC26)</b>	WT		<b>6,30</b>	mm	<b>0,25</b>	inch

<b>max. COPPIA senza TIRO</b>				<b>max. TIRO senza COPPIA</b>		
<b>max. TORQUE without PULLBACK</b>				<b>max. PULLBACK without TORQUE</b>		
<b>Nm</b>	<b>ft-lbs</b>	CS-TQ	CS-PB	<b>KN</b>	<b>lbs</b>	<b>TON</b>
21800	16079	P	P	1600	359756	163
9909,09	7309	P	P	727	163525	74
<b>Nm</b>	<b>ft-lbs</b>	CS-TQ	CS-PB	<b>KN</b>	<b>lbs</b>	<b>TON</b>
14180	10459	P	P	1048	235640	107
6445,45	4754	P	P	476	107109	49

WITH  
WITH  
WITH  
WITH

<b>TIPO DI MATERIALE</b>						
<b>MATERIAL GRADE</b>						
<b>GRADO</b>	Rm MIN		Re min		COEF. SICUREZZA	
<b>GRADE</b>	Rm MIN		Re min		SAFETY FACTOR	
	<b>Mpa</b>	<b>psi</b>	<b>Mpa</b>	<b>psi</b>	<b>CONDITIONS</b>	
S-135	1000	145000	931	135000	THEORETICAL	1
S-135	1000	145000	931	135000	UNDER FATIGUE	2,2
	<b>Mpa</b>	<b>psi</b>	<b>Mpa</b>	<b>psi</b>	<b>CONDITIONS</b>	
E355	650	94300	550	80000	THEORETICAL	1
E355	650	94300	550	80000	UNDER FATIGUE	2,2

<b>PESO</b>		<b>LUNGHEZZA</b>		<b>PIANI CHIAVE</b>			<b>LARGHEZZA E POSIZIONAMENTO PIANI CHIAVE</b>					<b>DIAM. INTERNO</b>		<b>CODICE PRODOTTO</b>	
<b>WEIGHT</b>		<b>LENGTH</b>		<b>BRANCH FLATS - WF</b>			<b>WF LENGTH - LWF</b>		<b>DP</b>		<b>DB</b>		<b>INTERNAL DIAM.</b>		<b>PRODUCT CODE</b>
Kg	lbs	mm	ft	n°	mm	inch	mm	inch	mm	inch	mm	inch	mm	inch	
18,5	40,8	1000	3,28	4	75	2,95	40	1,57	17,8	0,70	94	3,70	44	1,73	
25	55,1	1500	4,92	4	75	2,95	40	1,57	17,8	0,70	94	3,70	44	1,73	
32	70,6	2000	6,56	4	75	2,95	40	1,57	17,8	0,70	94	3,70	44	1,73	
45	99,2	3000	9,84	4	75	2,95	40	1,57	17,8	0,70	94	3,70	44	1,73	
64,5	142,2	4500	14,76	4	75	2,95	40	1,57	17,8	0,70	94	3,70	44	1,73	
84	185,2	6000	19,69	4	75	2,95	40	1,57	17,8	0,70	94	3,70	44	1,73	

<b>DRILL PIPES</b>	OD		<b>88,90</b>	mm	<b>3,50</b>	inch
<b>2 3/8 IF (NC26)</b>	WT		<b>4,00</b>	mm	<b>0,16</b>	inch

<b>max. COPPIA senza TIRO</b>				<b>max. TIRO senza COPPIA</b>		
<b>max. TORQUE without PULLBACK</b>				<b>max. PULLBACK without TORQUE</b>		
<b>Nm</b>	<b>ft-lbs</b>	CS-TQ	CS-PB	<b>KN</b>	<b>lbs</b>	<b>TON</b>
21800	16079	P	I	1067	239912	109
9909,09	7309	P	I	485	109051	49
<b>Nm</b>	<b>ft-lbs</b>	CS-TQ	CS-PB	<b>KN</b>	<b>lbs</b>	<b>TON</b>
14180	10459	P	I	693	155819	71
6445,45	4754	P	I	315	70827	32

WITH  
WITH  
WITH  
WITH

<b>TIPO DI MATERIALE</b>						
<b>MATERIAL GRADE</b>						
<b>GRADO</b>	Rm MIN		Re min		COEF. SICUREZZA	
<b>GRADE</b>	Rm MIN		Re min		SAFETY FACTOR	
	<b>Mpa</b>	<b>psi</b>	<b>Mpa</b>	<b>psi</b>	<b>CONDITIONS</b>	
S-135	1000	145000	931	135000	THEORETICAL	1
S-135	1000	145000	931	135000	UNDER FATIGUE	2,2
	<b>Mpa</b>	<b>psi</b>	<b>Mpa</b>	<b>psi</b>	<b>CONDITIONS</b>	
E355	650	94300	550	80000	THEORETICAL	1
E355	650	94300	550	80000	UNDER FATIGUE	2,2

<b>PESO</b>		<b>LUNGHEZZA</b>		<b>PIANI CHIAVE</b>			<b>LARGHEZZA E POSIZIONAMENTO PIANI CHIAVE</b>					<b>DIAM. INTERNO</b>		<b>CODICE PRODOTTO</b>	
<b>WEIGHT</b>		<b>LENGTH</b>		<b>BRANCH FLATS - WF</b>			<b>WF LENGTH - LWF</b>		<b>DP</b>		<b>DB</b>		<b>INTERNAL DIAM.</b>		<b>PRODUCT CODE</b>
Kg	lbs	mm	ft	n°	mm	inch	mm	inch	mm	inch	mm	inch	mm	inch	
15	33,1	1000	3,28	4	75	2,95	40	1,57	17,8	0,70	94	3,70	44	1,73	
19,5	43,0	1500	4,92	4	75	2,95	40	1,57	17,8	0,70	94	3,70	44	1,73	
24	52,9	2000	6,56	4	75	2,95	40	1,57	17,8	0,70	94	3,70	44	1,73	
32	70,6	3000	9,84	4	75	2,95	40	1,57	17,8	0,70	94	3,70	44	1,73	
45	99,2	4500	14,76	4	75	2,95	40	1,57	17,8	0,70	94	3,70	44	1,73	
58	127,9	6000	19,69	4	75	2,95	40	1,57	17,8	0,70	94	3,70	44	1,73	

COLLIDRILL PIPES SPECIFICATIONS

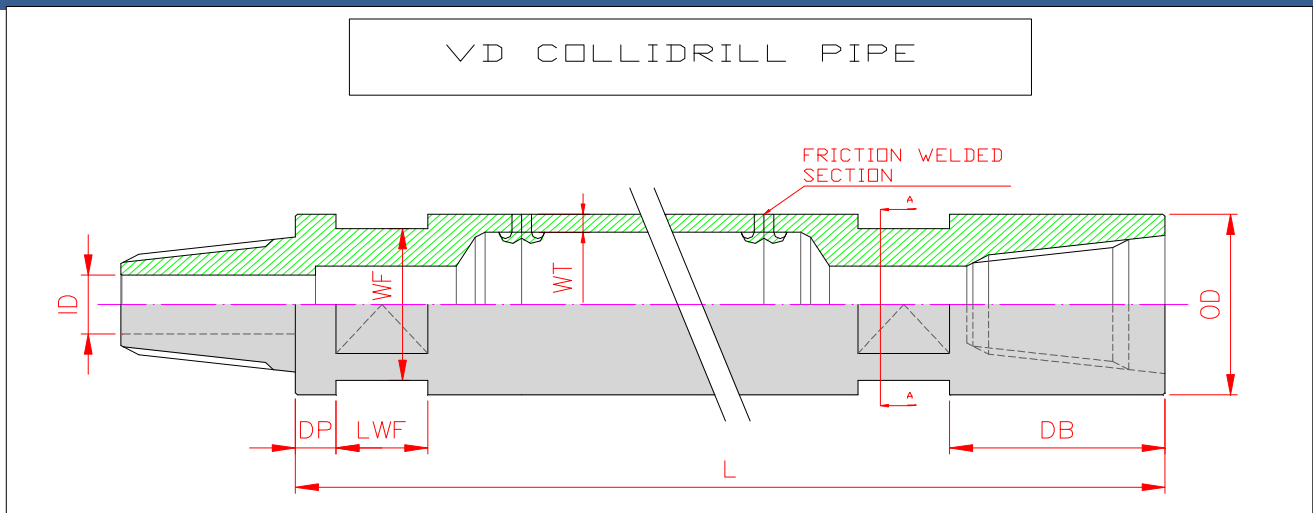

<b>DRILL PIPES</b>	OD		<b>88,90</b>	mm	<b>3,50</b>	inch
<b>2 7/8 AR</b>	WT		<b>6,30</b>	mm	<b>0,25</b>	inch

<b>max. COPPIA senza TIRO</b>				<b>max. TIRO senza COPPIA</b>		
<b>max. TORQUE without PULLBACK</b>				<b>max. PULLBACK without TORQUE</b>		
<b>Nm</b>	<b>ft-lbs</b>	CS-TQ	CS-PB	<b>KN</b>	<b>lbs</b>	<b>TON</b>
29460	21729	P	I	1635	367626	167
13390,9	9877	P	I	743	167103	76
<b>Nm</b>	<b>ft-lbs</b>	CS-TQ	CS-PB	<b>KN</b>	<b>lbs</b>	<b>TON</b>
19150	14124	P	I	1063	239013	108
8704,55	6420	P	I	483	108642	49

<b>TIPO DI MATERIALE</b>						
<b>MATERIAL GRADE</b>						
<b>GRADO</b>	Rm MIN		Re min		COEF. SICUREZZA	
<b>GRADE</b>	Rm MIN		Re min		SAFETY FACTOR	
	<b>Mpa</b>	<b>psi</b>	<b>Mpa</b>	<b>psi</b>	<b>CONDITIONS</b>	
WITH S-135	1000	145000	931	135000	THEORETICAL	1
WITH S-135	1000	145000	931	135000	UNDER FATIGUE	2,2
	<b>Mpa</b>	<b>psi</b>	<b>Mpa</b>	<b>psi</b>	<b>CONDITIONS</b>	
WITH E355	650	94300	550	80000	THEORETICAL	1
WITH E355	650	94300	550	80000	UNDER FATIGUE	2,2

<b>PESO</b>		<b>LUNGHEZZA</b>		<b>PIANI CHIAVE</b>			<b>LARGHEZZA E POSIZIONAMENTO PIANI CHIAVE</b>						<b>DIAM. INTERNO</b>		<b>CODICE PRODOTTO</b>	
<b>WEIGHT</b>		<b>LENGTH</b>		<b>WRANCH FLATS - WF</b>			<b>WF LENGTH - LWF</b>		<b>DP</b>		<b>DB</b>		<b>INTERNAL DIAM.</b>		<b>PRODUCT CODE</b>	
<b>Kg</b>	<b>lbs</b>	<b>mm</b>	<b>ft</b>	<b>n°</b>	<b>mm</b>	<b>inch</b>	<b>mm</b>	<b>inch</b>	<b>mm</b>	<b>inch</b>	<b>mm</b>	<b>inch</b>	<b>mm</b>	<b>inch</b>		
19	41,9	1000	3,28	4	75	2,95	40	1,57	13,1	0,52	102	4,02	32	1,26		
26	57,3	1500	4,92	4	75	2,95	40	1,57	13,1	0,52	102	4,02	32	1,26		
32	70,6	2000	6,56	4	75	2,95	40	1,57	13,1	0,52	102	4,02	32	1,26		
45	99,2	3000	9,84	4	75	2,95	40	1,57	13,1	0,52	102	4,02	32	1,26		
64,5	142,2	4500	14,76	4	75	2,95	40	1,57	13,1	0,52	102	4,02	32	1,26		
84	185,2	6000	19,69	4	75	2,95	40	1,57	13,1	0,52	102	4,02	32	1,26		

<b>DRILL PIPES</b>	OD		<b>88,90</b>	mm	<b>3,50</b>	inch
<b>2 7/8 AR</b>	WT		<b>4,00</b>	mm	<b>0,16</b>	inch

<b>max. COPPIA senza TIRO</b>				<b>max. TIRO senza COPPIA</b>		
<b>max. TORQUE without PULLBACK</b>				<b>max. PULLBACK without TORQUE</b>		
<b>Nm</b>	<b>ft-lbs</b>	CS-TQ	CS-PB	<b>KN</b>	<b>lbs</b>	<b>TON</b>
25025	18457	I	I	1067	239912	109
11375	8390	I	I	485	109051	49
<b>Nm</b>	<b>ft-lbs</b>	CS-TQ	CS-PB	<b>KN</b>	<b>lbs</b>	<b>TON</b>
16260	11993	I	I	693	155819	71
7390,91	5451	I	I	315	70827	32

<b>TIPO DI MATERIALE</b>						
<b>MATERIAL GRADE</b>						
<b>GRADO</b>	Rm MIN		Re min		COEF. SICUREZZA	
<b>GRADE</b>	Rm MIN		Re min		SAFETY FACTOR	
	<b>Mpa</b>	<b>psi</b>	<b>Mpa</b>	<b>psi</b>	<b>CONDITIONS</b>	
WITH S-135	1000	145000	931	135000	THEORETICAL	1
WITH S-135	1000	145000	931	135000	UNDER FATIGUE	2,2
	<b>Mpa</b>	<b>psi</b>	<b>Mpa</b>	<b>psi</b>	<b>CONDITIONS</b>	
WITH E355	650	94300	550	80000	THEORETICAL	1
WITH E355	650	94300	550	80000	UNDER FATIGUE	2,2

<b>PESO</b>		<b>LUNGHEZZA</b>		<b>PIANI CHIAVE</b>			<b>LARGHEZZA E POSIZIONAMENTO PIANI CHIAVE</b>						<b>DIAM. INTERNO</b>		<b>CODICE PRODOTTO</b>	
<b>WEIGHT</b>		<b>LENGTH</b>		<b>WRANCH FLATS - WF</b>			<b>WF LENGTH - LWF</b>		<b>DP</b>		<b>DB</b>		<b>INTERNAL DIAM.</b>		<b>PRODUCT CODE</b>	
<b>Kg</b>	<b>lbs</b>	<b>mm</b>	<b>ft</b>	<b>n°</b>	<b>mm</b>	<b>inch</b>	<b>mm</b>	<b>inch</b>	<b>mm</b>	<b>inch</b>	<b>mm</b>	<b>inch</b>	<b>mm</b>	<b>inch</b>		
15,5	34,2	1000	3,28	4	75	2,95	40	1,57	13,1	0,52	102	4,02	32	1,26		
20	44,1	1500	4,92	4	75	2,95	40	1,57	13,1	0,52	102	4,02	32	1,26		
24	52,9	2000	6,56	4	75	2,95	40	1,57	13,1	0,52	102	4,02	32	1,26		
33	72,8	3000	9,84	4	75	2,95	40	1,57	13,1	0,52	102	4,02	32	1,26		
46	101,4	4500	14,76	4	75	2,95	40	1,57	13,1	0,52	102	4,02	32	1,26		
58,5	129,0	6000	19,69	4	75	2,95	40	1,57	13,1	0,52	102	4,02	32	1,26		

COLLIDRILL PIPES SPECIFICATIONS

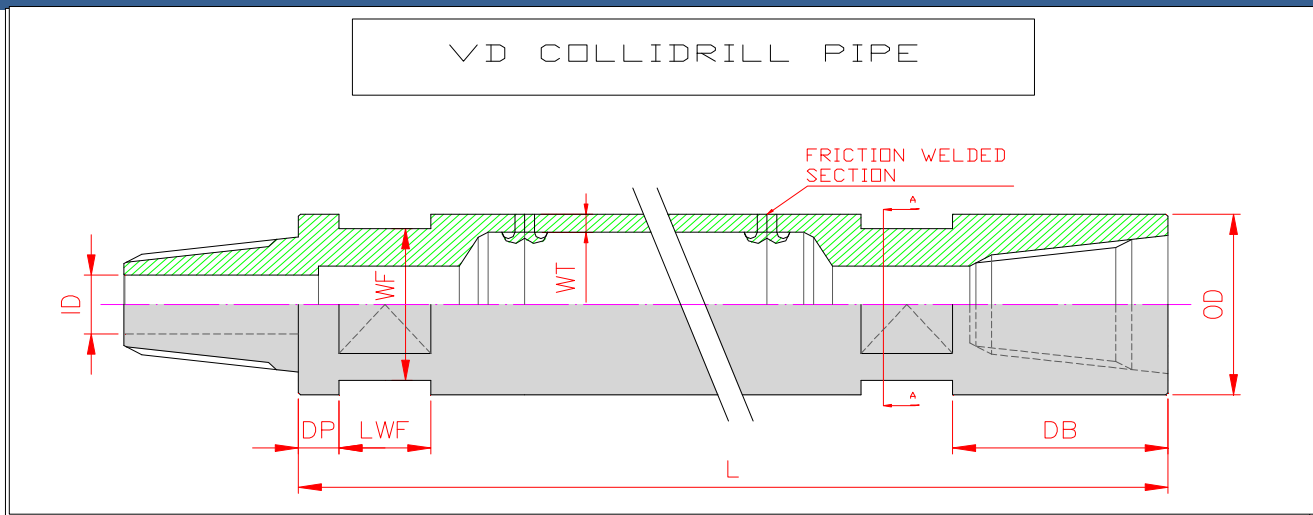

<b>DRILL PIPES</b>	OD	114,30	mm	4,50	inch
<b>3 1/2 AR</b>	WT	6,30	mm	0,25	inch

max. COPPIA senza TIRO				max. TIRO senza COPPIA		
max. TORQUE without PULLBACK				max. PULLBACK without TORQUE		
Nm	ft-lbs	CS-TQ	CS-PB	KN	lbs	TON
50340	37129	P	I	2138	480724	218
22881,8	16877	P	I	972	218511	99
Nm	ft-lbs	CS-TQ	CS-PB	KN	lbs	TON
32700	24118	P	I	1389	312313	142
14863,6	10963	P	I	631	141960	64

TIPO DI MATERIALE						
MATERIAL GRADE						
GRADO	Rm MIN		Re min		COEF. SICUREZZA	
GRADE	Rm MIN		Re min		SAFETY FACTOR	
	Mpa	psi	Mpa	psi	CONDITIONS	
WITH S-135	1000	145000	931	135000	THEORETICAL	1
WITH S-135	1000	145000	931	135000	UNDER FATIGUE	2,2
	Mpa	psi	Mpa	psi	CONDITIONS	
WITH E355	650	94300	550	80000	THEORETICAL	1
WITH E355	650	94300	550	80000	UNDER FATIGUE	2,2

PESO		LUNGHEZZA		PIANI CHIAVE			LARGHEZZA E POSIZIONAMENTO PIANI CHIAVE						DIAM. INTERNO		CODICE PRODOTTO
WEIGHT		LENGTH		WRANCH FLATS - WF			WF LENGTH - LWF		DP		DB		INTERNAL DIAM.		PRODUCT CODE
Kg	lbs	mm	ft	n°	mm	inch	mm	inch	mm	inch	mm	inch	mm	inch	
29	63,9	1000	3,28	4	90	3,54	40	1,57	14,75	0,58	110	4,33	38	1,50	
38	83,8	1500	4,92	4	90	3,54	40	1,57	14,75	0,58	110	4,33	38	1,50	
46,5	102,5	2000	6,56	4	90	3,54	40	1,57	14,75	0,58	110	4,33	38	1,50	
64	141,1	3000	9,84	4	90	3,54	40	1,57	14,75	0,58	110	4,33	38	1,50	
90	198,5	4500	14,76	4	90	3,54	40	1,57	14,75	0,58	110	4,33	38	1,50	
116	255,8	6000	19,69	4	90	3,54	40	1,57	14,75	0,58	110	4,33	38	1,50	

<b>DRILL PIPES</b>	OD	114,30	mm	4,50	inch
<b>3 1/2 AR</b>	WT	4,00	mm	0,16	inch

max. COPPIA senza TIRO				max. TIRO senza COPPIA		
max. TORQUE without PULLBACK				max. PULLBACK without TORQUE		
Nm	ft-lbs	CS-TQ	CS-PB	KN	lbs	TON
42600	31420	I	I	1386	311639	141
19363,6	14282	I	I	630	141654	64
Nm	ft-lbs	CS-TQ	CS-PB	KN	lbs	TON
27700	20430	I	I	901	202588	92
12590,9	9287	I	I	410	92085	42

TIPO DI MATERIALE						
MATERIAL GRADE						
GRADO	Rm MIN		Re min		COEF. SICUREZZA	
GRADE	Rm MIN		Re min		SAFETY FACTOR	
	Mpa	psi	Mpa	psi	CONDITIONS	
WITH S-135	1000	145000	931	135000	THEORETICAL	1
WITH S-135	1000	145000	931	135000	UNDER FATIGUE	2,2
	Mpa	psi	Mpa	psi	CONDITIONS	
WITH E355	650	94300	550	80000	THEORETICAL	1
WITH E355	650	94300	550	80000	UNDER FATIGUE	2,2

PESO		LUNGHEZZA		PIANI CHIAVE			LARGHEZZA E POSIZIONAMENTO PIANI CHIAVE						DIAM. INTERNO		CODICE PRODOTTO
WEIGHT		LENGTH		WRANCH FLATS - WF			WF LENGTH - LWF		DP		DB		INTERNAL DIAM.		PRODUCT CODE
Kg	lbs	mm	ft	n°	mm	inch	mm	inch	mm	inch	mm	inch	mm	inch	
25	55,1	1000	3,28	4	90	3,54	40	1,57	14,75	0,58	110	4,33	38	1,50	
30	66,2	1500	4,92	4	90	3,54	40	1,57	14,75	0,58	110	4,33	38	1,50	
36	79,4	2000	6,56	4	90	3,54	40	1,57	14,75	0,58	110	4,33	38	1,50	
47	103,6	3000	9,84	4	90	3,54	40	1,57	14,75	0,58	110	4,33	38	1,50	
64	141,1	4500	14,76	4	90	3,54	40	1,57	14,75	0,58	110	4,33	38	1,50	
80,5	177,5	6000	19,69	4	90	3,54	40	1,57	14,75	0,58	110	4,33	38	1,50	

COLLIDRILL PIPES SPECIFICATIONS

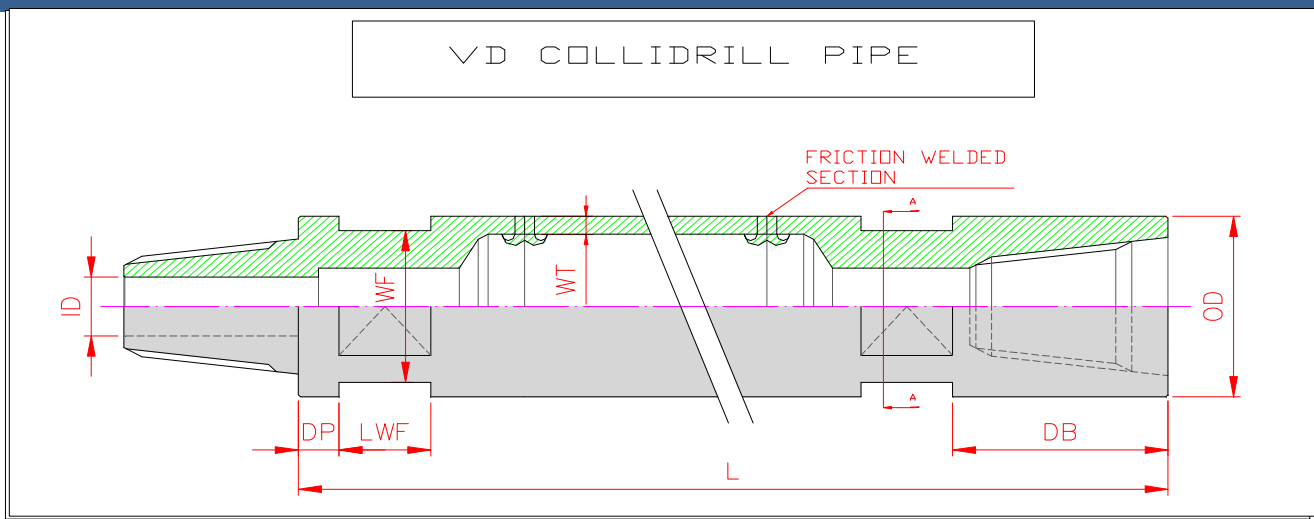

<b>DRILL PIPES</b>	OD	<b>114,30</b>	mm	<b>4,50</b>	inch
<b>3 1/2 IF (NC38)</b>	WT	<b>6,30</b>	mm	<b>0,25</b>	inch

<b>max. COPPIA senza TIRO</b>				<b>max. TIRO senza COPPIA</b>		
<b>max. TORQUE without PULLBACK</b>				<b>max. PULLBACK without TORQUE</b>		
<b>Nm</b>	<b>ft-lbs</b>	CS-TQ	CS-PB	<b>KN</b>	<b>lbs</b>	<b>TON</b>
63180	46599	I	I	2138	480724	218
28718,2	21181	I	I	972	218511	99
<b>Nm</b>	<b>ft-lbs</b>	CS-TQ	CS-PB	<b>KN</b>	<b>lbs</b>	<b>TON</b>
41050	30277	I	I	1389	312313	142
18659,1	13762	I	I	631	141960	64

<b>TIPO DI MATERIALE</b>						
<b>MATERIAL GRADE</b>						
<b>GRADO</b>	Rm MIN		Re min		COEF. SICUREZZA	
<b>GRADE</b>	Rm MIN		Re min		SAFETY FACTOR	
	<b>Mpa</b>	<b>psi</b>	<b>Mpa</b>	<b>psi</b>	<b>CONDITIONS</b>	
WITH S-135	1000	145000	931	135000	THEORETICAL	1
WITH S-135	1000	145000	931	135000	UNDER FATIGUE	2,2
	<b>Mpa</b>	<b>psi</b>	<b>Mpa</b>	<b>psi</b>	<b>CONDITIONS</b>	
WITH E355	650	94300	550	80000	THEORETICAL	1
WITH E355	650	94300	550	80000	UNDER FATIGUE	2,2

<b>PESO</b>		<b>LUNGHEZZA</b>		<b>PIANI CHIAVE</b>			<b>LARGHEZZA E POSIZIONAMENTO PIANI CHIAVE</b>					<b>DIAM. INTERNO</b>		<b>CODICE PRODOTTO</b>	
<b>WEIGHT</b>		<b>LENGTH</b>		<b>WRANCH FLATS - WF</b>			<b>WF LENGTH - LWF</b>		<b>DP</b>		<b>DB</b>		<b>INTERNAL DIAM.</b>		<b>PRODUCT CODE</b>
Kg	lbs	mm	ft	n°	mm	inch	mm	inch	mm	inch	mm	inch	mm	inch	
25,3	55,8	1000	3,28	4	90	3,54	40	1,57	18,4	0,72	120	4,72	65	2,56	
34	75,0	1500	4,92	4	90	3,54	40	1,57	18,4	0,72	120	4,72	65	2,56	
42,5	93,7	2000	6,56	4	90	3,54	40	1,57	18,4	0,72	120	4,72	65	2,56	
60	132,3	3000	9,84	4	90	3,54	40	1,57	18,4	0,72	120	4,72	65	2,56	
86	189,6	4500	14,76	4	90	3,54	40	1,57	18,4	0,72	120	4,72	65	2,56	
112	247,0	6000	19,69	4	90	3,54	40	1,57	18,4	0,72	120	4,72	65	2,56	

<b>DRILL PIPES</b>	OD	<b>114,30</b>	mm	<b>4,50</b>	inch
<b>3 1/2 IF (NC38)</b>	WT	<b>4,00</b>	mm	<b>0,16</b>	inch

<b>max. COPPIA senza TIRO</b>				<b>max. TIRO senza COPPIA</b>		
<b>max. TORQUE without PULLBACK</b>				<b>max. PULLBACK without TORQUE</b>		
<b>Nm</b>	<b>ft-lbs</b>	CS-TQ	CS-PB	<b>KN</b>	<b>lbs</b>	<b>TON</b>
42600	31420	I	I	1386	311639	141
19363,6	14282	I	I	630	141654	64
<b>Nm</b>	<b>ft-lbs</b>	CS-TQ	CS-PB	<b>KN</b>	<b>lbs</b>	<b>TON</b>
27700	20430	I	I	901	202588	92
12590,9	9287	I	I	410	92085	42

<b>TIPO DI MATERIALE</b>						
<b>MATERIAL GRADE</b>						
<b>GRADO</b>	Rm MIN		Re min		COEF. SICUREZZA	
<b>GRADE</b>	Rm MIN		Re min		SAFETY FACTOR	
	<b>Mpa</b>	<b>psi</b>	<b>Mpa</b>	<b>psi</b>	<b>CONDITIONS</b>	
WITH S-135	1000	145000	931	135000	THEORETICAL	1
WITH S-135	1000	145000	931	135000	UNDER FATIGUE	2,2
	<b>Mpa</b>	<b>psi</b>	<b>Mpa</b>	<b>psi</b>	<b>CONDITIONS</b>	
WITH E355	650	94300	550	80000	THEORETICAL	1
WITH E355	650	94300	550	80000	UNDER FATIGUE	2,2

<b>PESO</b>		<b>LUNGHEZZA</b>		<b>PIANI CHIAVE</b>			<b>LARGHEZZA E POSIZIONAMENTO PIANI CHIAVE</b>					<b>DIAM. INTERNO</b>		<b>CODICE PRODOTTO</b>	
<b>WEIGHT</b>		<b>LENGTH</b>		<b>WRANCH FLATS - WF</b>			<b>WF LENGTH - LWF</b>		<b>DP</b>		<b>DB</b>		<b>INTERNAL DIAM.</b>		<b>PRODUCT CODE</b>
Kg	lbs	mm	ft	n°	mm	inch	mm	inch	mm	inch	mm	inch	mm	inch	
21	46,3	1000	3,28	4	90	3,54	40	1,57	18,4	0,72	120	4,72	65	2,56	
26,5	58,4	1500	4,92	4	90	3,54	40	1,57	18,4	0,72	120	4,72	65	2,56	
32	70,6	2000	6,56	4	90	3,54	40	1,57	18,4	0,72	120	4,72	65	2,56	
43	94,8	3000	9,84	4	90	3,54	40	1,57	18,4	0,72	120	4,72	65	2,56	
60	132,3	4500	14,76	4	90	3,54	40	1,57	18,4	0,72	120	4,72	65	2,56	
77	169,8	6000	19,69	4	90	3,54	40	1,57	18,4	0,72	120	4,72	65	2,56	

COLLIDRILL PIPES SPECIFICATIONS

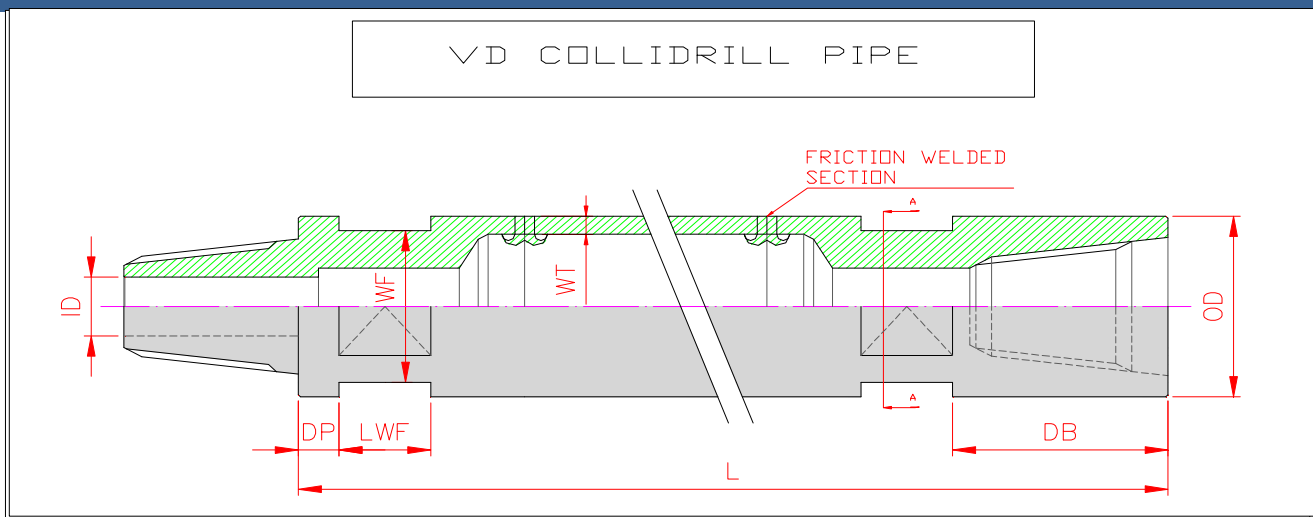

<b>DRILL PIPES</b>	OD	114,30	mm	4,50	inch
<b>3 1/2 AR</b>	WT	8,00	mm	0,31	inch

max. COPPIA senza TIRO				max. TIRO senza COPPIA		
max. TORQUE without PULLBACK				max. PULLBACK without TORQUE		
Nm	ft-lbs	CS-TQ	CS-PB	KN	lbs	TON
50340	37129	P	I	2670	600343	272
22881,8	16877	P	I	1214	272883	124
Nm	ft-lbs	CS-TQ	CS-PB	KN	lbs	TON
32700	24118	P	I	1737	390560	177
14863,6	10963	P	I	790	177527	81

TIPO DI MATERIALE						
MATERIAL GRADE						
GRADO	Rm MIN		Re min		COEF. SICUREZZA	
GRADE	Rm MIN		Re min		SAFETY FACTOR	
	Mpa	psi	Mpa	psi	CONDITIONS	
WITH S-135	1000	145000	931	135000	THEORETICAL	1
WITH S-135	1000	145000	931	135000	UNDER FATIGUE	2,2
	Mpa	psi	Mpa	psi	CONDITIONS	
WITH E355	650	94300	550	80000	THEORETICAL	1
WITH E355	650	94300	550	80000	UNDER FATIGUE	2,2

PESO		LUNGHEZZA		PIANI CHIAVE			LARGHEZZA E POSIZIONAMENTO PIANI CHIAVE						DIAM. INTERNO		CODICE PRODOTTO
WEIGHT		LENGTH		WRANCH FLATS - WF			WF LENGTH - LWF		DP		DB		INTERNAL DIAM.		PRODUCT CODE
Kg	lbs	mm	ft	n°	mm	inch	mm	inch	mm	inch	mm	inch	mm	inch	
32,3	71,2	1000	3,28	4	90	3,54	40	1,57	14,75	0,58	110	4,33	38	1,50	
43	94,8	1500	4,92	4	90	3,54	40	1,57	14,75	0,58	110	4,33	38	1,50	
54	119,1	2000	6,56	4	90	3,54	40	1,57	14,75	0,58	110	4,33	38	1,50	
75,3	166,0	3000	9,84	4	90	3,54	40	1,57	14,75	0,58	110	4,33	38	1,50	
107,5	237,0	4500	14,76	4	90	3,54	40	1,57	14,75	0,58	110	4,33	38	1,50	
140	308,7	6000	19,69	4	90	3,54	40	1,57	14,75	0,58	110	4,33	38	1,50	

<b>DRILL PIPES</b>	OD	114,30	mm	4,50	inch
<b>3 1/2 IF (NC38)</b>	WT	8,00	mm	0,31	inch

max. COPPIA senza TIRO				max. TIRO senza COPPIA		
max. TORQUE without PULLBACK				max. PULLBACK without TORQUE		
Nm	ft-lbs	CS-TQ	CS-PB	KN	lbs	TON
68150	50265	P	I	2670	600343	272
30977,3	22848	P	I	1214	272883	124
Nm	ft-lbs	CS-TQ	CS-PB	KN	lbs	TON
44300	32674	P	I	1730	388986	176
20136,4	14852	P	I	786	176812	80

TIPO DI MATERIALE						
MATERIAL GRADE						
GRADO	Rm MIN		Re min		COEF. SICUREZZA	
GRADE	Rm MIN		Re min		SAFETY FACTOR	
	Mpa	psi	Mpa	psi	CONDITIONS	
WITH S-135	1000	145000	931	135000	THEORETICAL	1
WITH S-135	1000	145000	931	135000	UNDER FATIGUE	2,2
	Mpa	psi	Mpa	psi	CONDITIONS	
WITH E355	650	94300	550	80000	THEORETICAL	1
WITH E355	650	94300	550	80000	UNDER FATIGUE	2,2

PESO		LUNGHEZZA		PIANI CHIAVE			LARGHEZZA E POSIZIONAMENTO PIANI CHIAVE						DIAM. INTERNO		CODICE PRODOTTO
WEIGHT		LENGTH		WRANCH FLATS - WF			WF LENGTH - LWF		DP		DB		INTERNAL DIAM.		PRODUCT CODE
Kg	lbs	mm	ft	n°	mm	inch	mm	inch	mm	inch	mm	inch	mm	inch	
28,5	62,8	1000	3,28	4	90	3,54	40	1,57	18,4	0,72	120	4,72	65	2,56	
39	86,0	1500	4,92	4	90	3,54	40	1,57	18,4	0,72	120	4,72	65	2,56	
50	110,3	2000	6,56	4	90	3,54	40	1,57	18,4	0,72	120	4,72	65	2,56	
71,5	157,7	3000	9,84	4	90	3,54	40	1,57	18,4	0,72	120	4,72	65	2,56	
104	229,3	4500	14,76	4	90	3,54	40	1,57	18,4	0,72	120	4,72	65	2,56	
136	299,9	6000	19,69	4	90	3,54	40	1,57	18,4	0,72	120	4,72	65	2,56	

COLLIDRILL PIPES SPECIFICATIONS

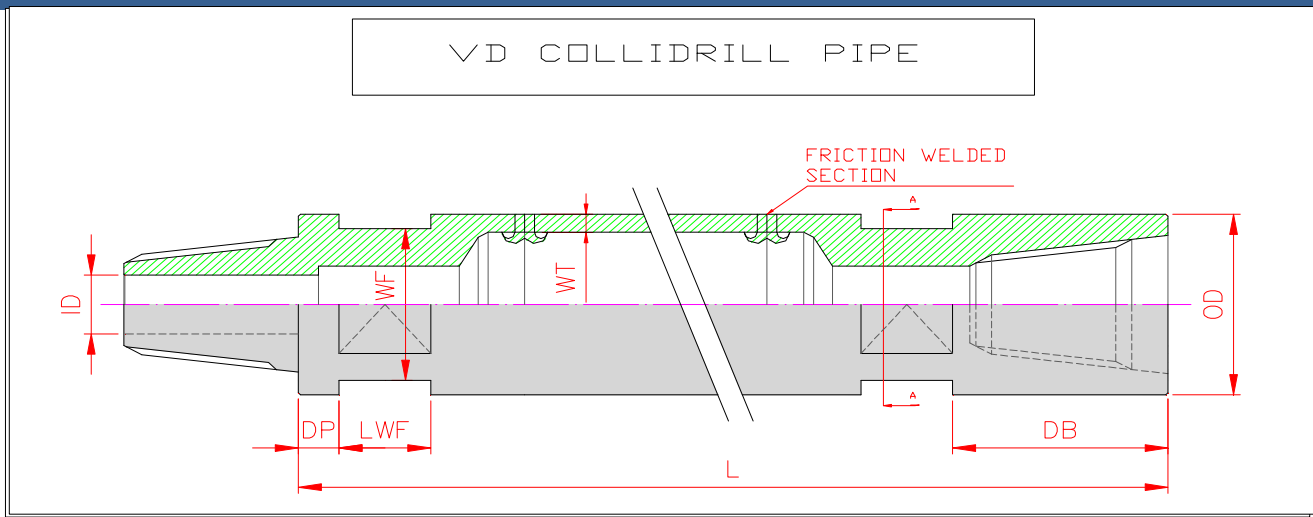

<b>DRILL PIPES</b>	OD	127,00	mm	5,00	inch
<b>3 1/2 IF (NC38)</b>	WT	8,00	mm	0,31	inch

max. COPPIA senza TIRO				max. TIRO senza COPPIA		
max. TORQUE without PULLBACK				max. PULLBACK without TORQUE		
Nm	ft-lbs	CS-TQ	CS-PB	KN	lbs	TON
68150	50265	P	I	2990	672294	305
30977,3	22848	P	I	1359	305588	139
Nm	ft-lbs	CS-TQ	CS-PB	KN	lbs	TON
44300	32674	P	I	1944	437103	198
20136,4	14852	P	I	884	198683	90

TIPO DI MATERIALE						
MATERIAL GRADE						
GRADO	Rm MIN		Re min		COEF. SICUREZZA	
GRADE	Rm MIN		Re min		SAFETY FACTOR	
	Mpa	psi	Mpa	psi	CONDITIONS	
WITH S-135	1000	145000	931	135000	THEORETICAL	1
WITH S-135	1000	145000	931	135000	UNDER FATIGUE	2,2
	Mpa	psi	Mpa	psi	CONDITIONS	
WITH E355	650	94300	550	80000	THEORETICAL	1
WITH E355	650	94300	550	80000	UNDER FATIGUE	2,2

PESO		LUNGHEZZA		PIANI CHIAVE			LARGHEZZA E POSIZIONAMENTO PIANI CHIAVE						DIAM. INTERNO		CODICE PRODOTTO
WEIGHT		LENGTH		WRANCH FLATS - WF			WF LENGTH - LWF		DP		DB		INTERNAL DIAM.		PRODUCT CODE
Kg	lbs	mm	ft	n°	mm	inch	mm	inch	mm	inch	mm	inch	mm	inch	
37	81,6	1000	3,28	4	105	4,13	40	1,57	23,5	0,93	125	4,92	65	2,56	
49	108,0	1500	4,92	4	105	4,13	40	1,57	23,5	0,93	125	4,92	65	2,56	
61	134,5	2000	6,56	4	105	4,13	40	1,57	23,5	0,93	125	4,92	65	2,56	
85	187,4	3000	9,84	4	105	4,13	40	1,57	23,5	0,93	125	4,92	65	2,56	
121	266,8	4500	14,76	4	105	4,13	40	1,57	23,5	0,93	125	4,92	65	2,56	
154	339,6	6000	19,69	4	105	4,13	40	1,57	23,5	0,93	125	4,92	65	2,56	

<b>DRILL PIPES</b>	OD	127,00	mm	5,00	inch
<b>3 1/2 IF (NC38)</b>	WT	6,30	mm	0,25	inch

max. COPPIA senza TIRO				max. TIRO senza COPPIA		
max. TORQUE without PULLBACK				max. PULLBACK without TORQUE		
Nm	ft-lbs	CS-TQ	CS-PB	KN	lbs	TON
68150	50265	P	I	2389	537160	244
30977,3	22848	P	I	1086	244164	111
Nm	ft-lbs	CS-TQ	CS-PB	KN	lbs	TON
44300	32674	P	I	1553	349188	158
20136,4	14852	P	I	706	158722	72

TIPO DI MATERIALE						
MATERIAL GRADE						
GRADO	Rm MIN		Re min		COEF. SICUREZZA	
GRADE	Rm MIN		Re min		SAFETY FACTOR	
	Mpa	psi	Mpa	psi	CONDITIONS	
WITH S-135	1000	145000	931	135000	THEORETICAL	1
WITH S-135	1000	145000	931	135000	UNDER FATIGUE	2,2
	Mpa	psi	Mpa	psi	CONDITIONS	
WITH E355	650	94300	550	80000	THEORETICAL	1
WITH E355	650	94300	550	80000	UNDER FATIGUE	2,2

PESO		LUNGHEZZA		PIANI CHIAVE			LARGHEZZA E POSIZIONAMENTO PIANI CHIAVE						DIAM. INTERNO		CODICE PRODOTTO
WEIGHT		LENGTH		WRANCH FLATS - WF			WF LENGTH - LWF		DP		DB		INTERNAL DIAM.		PRODUCT CODE
Kg	lbs	mm	ft	n°	mm	inch	mm	inch	mm	inch	mm	inch	mm	inch	
32,3	71,2	1000	3,28	4	105	4,13	40	1,57	23,5	0,93	125	4,92	65	2,56	
41,6	91,7	1500	4,92	4	105	4,13	40	1,57	23,5	0,93	125	4,92	65	2,56	
50,9	112,2	2000	6,56	4	105	4,13	40	1,57	23,5	0,93	125	4,92	65	2,56	
69,7	153,7	3000	9,84	4	105	4,13	40	1,57	23,5	0,93	125	4,92	65	2,56	
98	216,1	4500	14,76	4	105	4,13	40	1,57	23,5	0,93	125	4,92	65	2,56	
126	277,8	6000	19,69	4	105	4,13	40	1,57	23,5	0,93	125	4,92	65	2,56	

COLLIDRILL PIPES SPECIFICATIONS

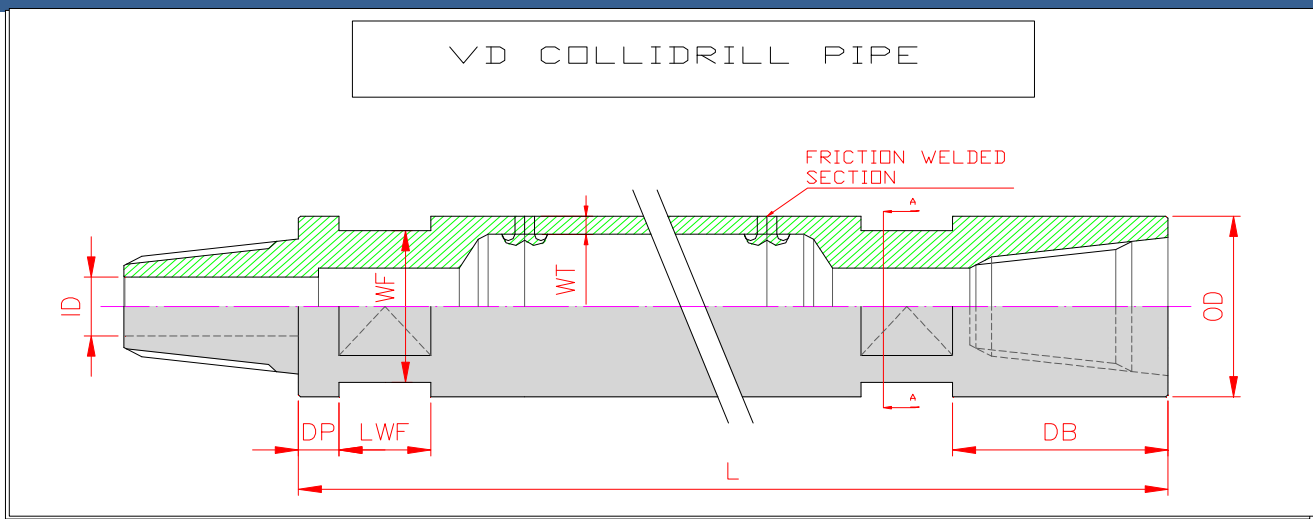

<b>DRILL PIPES</b>	OD	139,70	mm	5,50	inch
<b>4 1/2 AR</b>	WT	8,00	mm	0,31	inch

max. COPPIA senza TIRO				max. TIRO senza COPPIA		
max. TORQUE without PULLBACK				max. PULLBACK without TORQUE		
Nm	ft-lbs	CS-TQ	CS-PB	KN	lbs	TON
119000	87770	I	I	3310	744245	338
54090,9	39895	I	I	1505	338293	153
Nm	ft-lbs	CS-TQ	CS-PB	KN	lbs	TON
77390	57080	P	I	2151	483647	219
35177,3	25945	P	I	978	219839	100

TIPO DI MATERIALE						
MATERIAL GRADE						
GRADO	Rm MIN		Re min		COEF. SICUREZZA	
GRADE	Rm MIN		Re min		SAFETY FACTOR	
	Mpa	psi	Mpa	psi	CONDITIONS	
WITH S-135	1000	145000	931	135000	THEORETICAL	1
WITH S-135	1000	145000	931	135000	UNDER FATIGUE	2,2
	Mpa	psi	Mpa	psi	CONDITIONS	
WITH E355	650	94300	550	80000	THEORETICAL	1
WITH E355	650	94300	550	80000	UNDER FATIGUE	2,2

PESO		LUNGHEZZA		PIANI CHIAVE			LARGHEZZA E POSIZIONAMENTO PIANI CHIAVE						DIAM. INTERNO		CODICE PRODOTTO
WEIGHT		LENGTH		WRANCH FLATS - WF			WF LENGTH - LWF		DP		DB		INTERNAL DIAM.		PRODUCT CODE
Kg	lbs	mm	ft	n°	mm	inch	mm	inch	mm	inch	mm	inch	mm	inch	
45	99,2	1000	3,28	4	120	4,72	40	1,57	17,05	0,67	125	4,92	60	2,36	
59	130,1	1500	4,92	4	120	4,72	40	1,57	17,05	0,67	125	4,92	60	2,36	
73	161,0	2000	6,56	4	120	4,72	40	1,57	17,05	0,67	125	4,92	60	2,36	
100	220,5	3000	9,84	4	120	4,72	40	1,57	17,05	0,67	125	4,92	60	2,36	
140	308,7	4500	14,76	4	120	4,72	40	1,57	17,05	0,67	125	4,92	60	2,36	
185	407,9	6000	19,69	4	120	4,72	40	1,57	17,05	0,67	125	4,92	60	2,36	

<b>DRILL PIPES</b>	OD	139,70	mm	5,50	inch
<b>4 1/2 AR</b>	WT	6,30	mm	0,25	inch

max. COPPIA senza TIRO				max. TIRO senza COPPIA		
max. TORQUE without PULLBACK				max. PULLBACK without TORQUE		
Nm	ft-lbs	CS-TQ	CS-PB	KN	lbs	TON
97300	71765	I	I	2640	593597	269
44227,3	32620	I	I	1200	269817	122
Nm	ft-lbs	CS-TQ	CS-PB	KN	lbs	TON
63240	46643	P	I	1716	385838	175
28745,5	21201	P	I	780	175381	80

TIPO DI MATERIALE						
MATERIAL GRADE						
GRADO	Rm MIN		Re min		COEF. SICUREZZA	
GRADE	Rm MIN		Re min		SAFETY FACTOR	
	Mpa	psi	Mpa	psi	CONDITIONS	
WITH S-135	1000	145000	931	135000	THEORETICAL	1
WITH S-135	1000	145000	931	135000	UNDER FATIGUE	2,2
	Mpa	psi	Mpa	psi	CONDITIONS	
WITH E355	650	94300	550	80000	THEORETICAL	1
WITH E355	650	94300	550	80000	UNDER FATIGUE	2,2

PESO		LUNGHEZZA		PIANI CHIAVE			LARGHEZZA E POSIZIONAMENTO PIANI CHIAVE						DIAM. INTERNO		CODICE PRODOTTO
WEIGHT		LENGTH		WRANCH FLATS - WF			WF LENGTH - LWF		DP		DB		INTERNAL DIAM.		PRODUCT CODE
Kg	lbs	mm	ft	n°	mm	inch	mm	inch	mm	inch	mm	inch	mm	inch	
38,6	85,1	1000	3,28	4	120	4,72	40	1,57	17,05	0,67	125	4,92	60	2,36	
49	108,0	1500	4,92	4	120	4,72	40	1,57	17,05	0,67	125	4,92	60	2,36	
59,4	131,0	2000	6,56	4	120	4,72	40	1,57	17,05	0,67	125	4,92	60	2,36	
80,1	176,6	3000	9,84	4	120	4,72	40	1,57	17,05	0,67	125	4,92	60	2,36	
111	244,8	4500	14,76	4	120	4,72	40	1,57	17,05	0,67	125	4,92	60	2,36	
142,2	313,6	6000	19,69	4	120	4,72	40	1,57	17,05	0,67	125	4,92	60	2,36	

COLLIDRILL PIPES SPECIFICATIONS

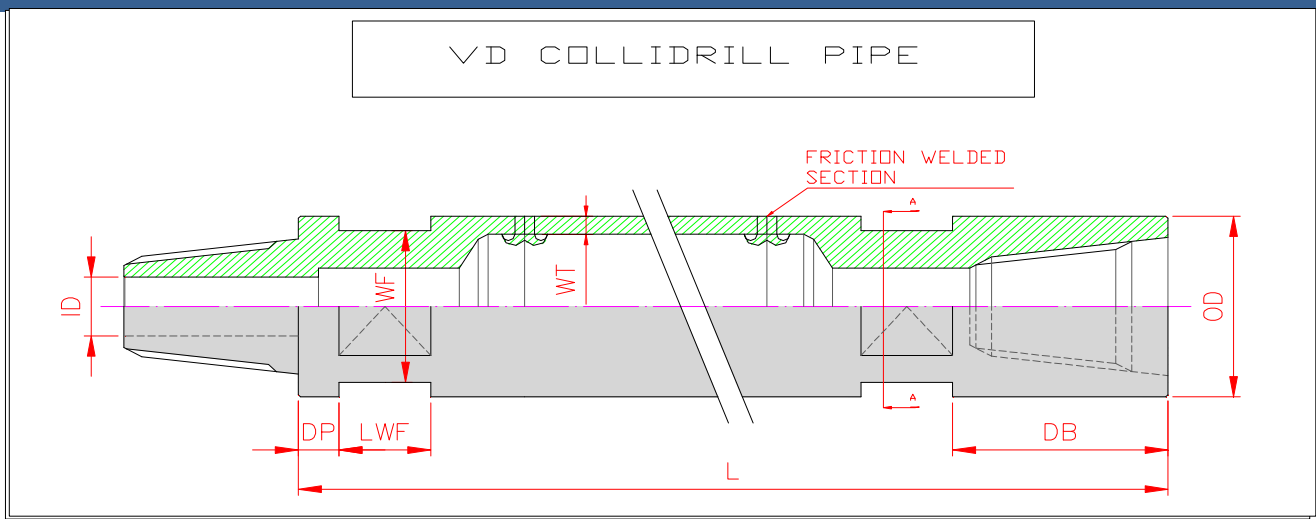

<b>DRILL PIPES</b>	OD	139,70	mm	5,50	inch
<b>4 FH (NC40)</b>	WT	8,00	mm	0,31	inch

max. COPPIA senza TIRO				max. TIRO senza COPPIA		
max. TORQUE without PULLBACK				max. PULLBACK without TORQUE		
Nm	ft-lbs	CS-TQ	CS-PB	KN	lbs	TON
103390	76256	P	I	3310	744245	338
46995,5	34662	P	I	1505	338293	153
Nm	ft-lbs	CS-TQ	CS-PB	KN	lbs	TON
67200	49564	P	I	2151	483647	219
30545,5	22529	P	I	978	219839	100

TIPO DI MATERIALE						
MATERIAL GRADE						
GRADO	Rm MIN		Re min		COEF. SICUREZZA	
GRADE	Rm MIN		Re min		SAFETY FACTOR	
	Mpa	psi	Mpa	psi	CONDITIONS	
WITH S-135	1000	145000	931	135000	THEORETICAL	1
WITH S-135	1000	145000	931	135000	UNDER FATIGUE	2,2
	Mpa	psi	Mpa	psi	CONDITIONS	
WITH E355	650	94300	550	80000	THEORETICAL	1
WITH E355	650	94300	550	80000	UNDER FATIGUE	2,2

PESO		LUNGHEZZA		PIANI CHIAVE			LARGHEZZA E POSIZIONAMENTO PIANI CHIAVE						DIAM. INTERNO		CODICE PRODOTTO
WEIGHT		LENGTH		WRANCH FLATS - WF			WF LENGTH - LWF		DP		DB		INTERNAL DIAM.		PRODUCT CODE
Kg	lbs	mm	ft	n°	mm	inch	mm	inch	mm	inch	mm	inch	mm	inch	
45	99,2	1000	3,28	4	120	4,72	40	1,57	20,7	0,81	141	5,55	50,8	2,00	
59	130,1	1500	4,92	4	120	4,72	40	1,57	20,7	0,81	141	5,55	50,8	2,00	
73	161,0	2000	6,56	4	120	4,72	40	1,57	20,7	0,81	141	5,55	50,8	2,00	
100	220,5	3000	9,84	4	120	4,72	40	1,57	20,7	0,81	141	5,55	50,8	2,00	
140	308,7	4500	14,76	4	120	4,72	40	1,57	20,7	0,81	141	5,55	50,8	2,00	
185	407,9	6000	19,69	4	120	4,72	40	1,57	20,7	0,81	141	5,55	50,8	2,00	

<b>DRILL PIPES</b>	OD	139,70	mm	5,50	inch
<b>4 FH (NC40)</b>	WT	6,30	mm	0,25	inch

max. COPPIA senza TIRO				max. TIRO senza COPPIA		
max. TORQUE without PULLBACK				max. PULLBACK without TORQUE		
Nm	ft-lbs	CS-TQ	CS-PB	KN	lbs	TON
97300	71765	I	I	2640	593597	269
44227,3	32620	I	I	1200	269817	122
Nm	ft-lbs	CS-TQ	CS-PB	KN	lbs	TON
63240	46643	P	I	1716	385838	175
28745,5	21201	P	I	780	175381	80

TIPO DI MATERIALE						
MATERIAL GRADE						
GRADO	Rm MIN		Re min		COEF. SICUREZZA	
GRADE	Rm MIN		Re min		SAFETY FACTOR	
	Mpa	psi	Mpa	psi	CONDITIONS	
WITH S-135	1000	145000	931	135000	THEORETICAL	1
WITH S-135	1000	145000	931	135000	UNDER FATIGUE	2,2
	Mpa	psi	Mpa	psi	CONDITIONS	
WITH E355	650	94300	550	80000	THEORETICAL	1
WITH E355	650	94300	550	80000	UNDER FATIGUE	2,2

PESO		LUNGHEZZA		PIANI CHIAVE			LARGHEZZA E POSIZIONAMENTO PIANI CHIAVE						DIAM. INTERNO		CODICE PRODOTTO
WEIGHT		LENGTH		WRANCH FLATS - WF			WF LENGTH - LWF		DP		DB		INTERNAL DIAM.		PRODUCT CODE
Kg	lbs	mm	ft	n°	mm	inch	mm	inch	mm	inch	mm	inch	mm	inch	
38,6	85,1	1000	3,28	4	120	4,72	40	1,57	20,7	0,81	141	5,55	50,8	2,00	
49	108,0	1500	4,92	4	120	4,72	40	1,57	20,7	0,81	141	5,55	50,8	2,00	
59,4	131,0	2000	6,56	4	120	4,72	40	1,57	20,7	0,81	141	5,55	50,8	2,00	
80,1	176,6	3000	9,84	4	120	4,72	40	1,57	20,7	0,81	141	5,55	50,8	2,00	
111	244,8	4500	14,76	4	120	4,72	40	1,57	20,7	0,81	141	5,55	50,8	2,00	
142,2	313,6	6000	19,69	4	120	4,72	40	1,57	20,7	0,81	141	5,55	50,8	2,00	